

Light Prefab Warehouse Buildings Q235 Q355 Metal Steel Structure

Our Product Introduction

for more products please visit us on baodupanel.com

Basic Information

- Place of Origin: Hebei, China
- Brand Name: BAODU
- Certification: ISO9001, CE
- Model Number: Steel Warehouse
- Minimum Order Quantity: Discussible
- Price: Discussible
- Packaging Details: In general, for steel structure, we use the steel frame packing to keep goods not to be broken. For sandwich panel and color steel sheet, we use the plastic packing. If the clients need special packing will according to their requirements.
- Delivery Time: 21 days
- Payment Terms: L/C, D/A, D/P, T/T, Western Union, MoneyGram
- Supply Ability: 10000 Square Meter/Square Meters per Month



Product Specification

- Product Name: Steel Structure Warehouse
- Purlin: C.Z Shape Steel
- Grade: Q235, Q355
- Maintenance: Low
- Processing Service: Bending, Welding, Decoiling, Cutting, Punching
- Roof And Wall: Corrugated/EPS/PU/Rock Wool/glass Wool
- Security: High
- Fire Resistance: High
- Installation: Easy
- Highlight: Light prefab warehouse buildings, Q355 Steel prefab warehouse buildings, Q235 prefab metal warehouse

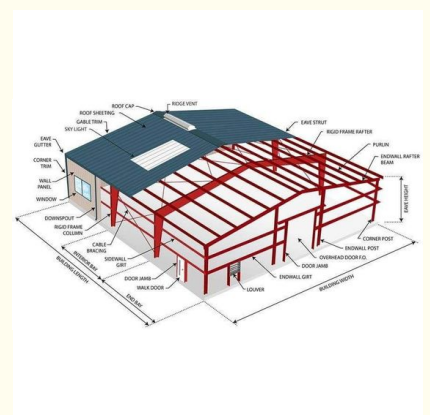

Product Description

Prefabricated Sheet Light Structure Steel Structure Building Warehouse

Product Description:

Structural steel warehouses are manufactured in different characteristics, static and sizes, both domestic and abroad. Depending on the area in which the steel warehouse structure is to be installed, the type of insulation used on the walls and roof is among these variable offerings. It is very important to correctly identify this isolation. Because isolation plays a key role in protecting and extending the life of products stored in steel warehouses. Steel warehouses are very durable, robust and lightweight because the raw material is steel. Steel warehouses are highly preferred, thanks to the fact that it is a durable product that can be easily installed and removed, which is cheaper and more environmentally friendly, and its production is very fast.

Your trustworthy and reliable partner:

Competitive Price

With over 12 years of experience in steel structure industry, BAODU can provide the most reasonable and economical scheme to prevent over designs.

Long term partnerships with raw material product suppliers give us the ability to control quality and price effectively.

Large-scale production reduces our procurement, production and management costs, which can bring customers more economic benefits.

We produce both steel structure (frame) and wall and roof panels, reducing external sourcing, ensuring consistency in product quality and further saving on costs.

Vast Experience in the foreign projects

In the past 13 years, BAODU's products are exported to more than 50 countries and regions, we have vast experience in design, transportation and overseas installation. Do not worry that you are far away from us, whether Asia, Oceania, America or Africa, we can provide installation workers or installation instructions according to customer needs for the project. For us, the end of a project is not you pay us to get the products, but you successfully complete the installation of our products.

Good Quality

Quality first, which is the key to our success in these years. We develop new technologies to improve the performance of our products, even if using the same raw materials, our products will be in more high quality.

Reputation

Our company have a good reputation and credibility in the industry. The customers that we have cooperated evaluate our company as follow, "This is a professional company, which has good service attitude, which really solves problem for customers, which can be trusted by the customers. It's a great thing to cooperate with such a company. You don't need to worry about the quality of the products, don't need to worry about the transport and installation. They will give you the most reasonable and economical design, transportation and installation plan"

Technical Parameters:

Prefabricated Sheet Light Structure Steel Structure Building Warehouse

Purlin	C Section or Z Section
Roof/Wall Cladding	Corrugated plate, PU, EPS, Rock Wool, Fiber Glass sandwich panel
Tie bar	Round Steel Tube
Brace	angle steel, round bar or steel pipe
Knee Brace	Angle Steel
Roof Gutter	Color Steel Sheet
Rain spout	PVC Pipe
Door	Sliding Sandwich Panel Door or Metal rolling door
Windows	PVC/Plastic Steel/Aluminum Alloy Window
Connecting	High Strengthen Bolts, Normal bolts with nuts
Packing	As per your request
Drawing	We can make the design and quotation according to your detailed conditions or as per your drawin
After-sale Service	Online technical support, Onsite Installation, Onsite Training, Onsite Inspection, Free spare parts, Return and Replacement, Other, workshop, warehouse, prefabricated steel structure building, low cost prefab warehouse
Project Solution Capability	graphic design, 3D model design, total solution for projects, Cross Categories Consolidation, Others, steel Structure Prefabricated workshop warehouse, prefabricated steel structure building, low cost prefab warehouse

Customization:

Welcome to BAODU's Steel Warehouse! Our Steel Warehouse is designed with gable frame Steel Structure and is perfect for warehouse workshop, hangar hall, and other steel structure needs. Our Steel Warehouse is certified with ISO9001, CE and has a minimum order quantity that is discussible.

For packing, we use steel frame packing for steel structure and plastic packing for sandwich panel and color steel sheet; we are also open to special packing

requests. Our delivery time is 21 days and we accept payment terms such as L/C, D/A, D/P, T/T, Western Union, and MoneyGram. We have a supply ability of 10000 Square Meter/Square Meters per Month.

Our Steel Warehouse features aluminum alloy windows, plastic steel, long fatigue life, and roof and walls made of corrugated/EPS/PU/Rock Wool/Glass Wool. Our processing services include bending, welding, decoiling, cutting, and punching.

If you have any questions about our Steel Warehouse, please do not hesitate to contact us. Thank you for your interest in BAODU's Steel Warehouse!

Support and Services:

Technical Support and Service for Steel Warehouse

Steel Warehouse provides comprehensive technical support and service. Our team of experienced professionals are available to assist you with product specific questions, installation and training, and custom solutions. We can answer your questions promptly and provide you with timely solutions to your technical issues. 24 hours to reply, 48 hours to give solutions.

1. Someone will contact you to confirm the details of the entire project, pick you up from the airport, and escort you and your client to our factory.
2. Project managers and bosses will discuss with you and your client.
3. Engineers provide technical guidance and installation locally.

Packing and Shipping:



FAQ:

Q&A for Steel Warehouse

Q: What is the brand name of Steel Warehouse?

A: The brand name of Steel Warehouse is BAODU.

Q: What is the model number of Steel Warehouse?

A: The model number of Steel Warehouse is Steel Warehouse.

Q: Where is the origin of Steel Warehouse?

A: The origin of Steel Warehouse is Hebei, China.

Q: What is the certification of Steel Warehouse?

A: The certification of Steel Warehouse is ISO9001, CE.

Q: What is the minimum order quantity of Steel Warehouse?

A: The minimum order quantity of Steel Warehouse is discussible.



Baodu International Advanced Construction Material Co., Ltd.

+86 13717927965

chunlei.song@baodu.com

baodupanel.com

Room 1101, Building 6, Yard 9, Hongye Road, Daxing District, Beijing